



2 Chambers Court, Brigg, DN20 0DN

£195,000

This is a really lovely, three bed semi detached new build property situated in a quiet cul de sac in Broughton.

The open plan living kitchen area is the real focus point of the ground floor, decorated in a neutral contemporary style and with Bi Fold doors overlooking the garden, the space really is great for entertaining. Downstairs there is also an entrance hall and a downstairs W.C, whilst upstairs there are two double bedrooms, a further third bedroom and a family bathroom. Outside there are two off road parking spaces and a private secure, rear lawned South facing garden with decking area.

Viewings are available now, so to book give us a call!

Entrance Hall 12'11" x 4'2" (3.96 x 1.29)

Open Plan Kitchen Living Area 24'1" x 14'8" (7.35 x 4.49)



Downstairs W.C. 3'7" x 2'3" (1.1 x 0.71)

First Floor Landing 8'6" x 6'4" (2.6 x 1.95)

Bedroom One 11'5" x 9'7" (3.48 x 2.93)



Bedroom Three 8'7" x 6'5" (2.63 x 1.96)



Family Bathroom 7'8" x 6'1" (2.36 x 1.86)



Outside



Bedroom Two 12'4" x 9'7" (3.76 x 2.93)



Ground Floor

Approx. 36.4 sq. metres (392.3 sq. feet)

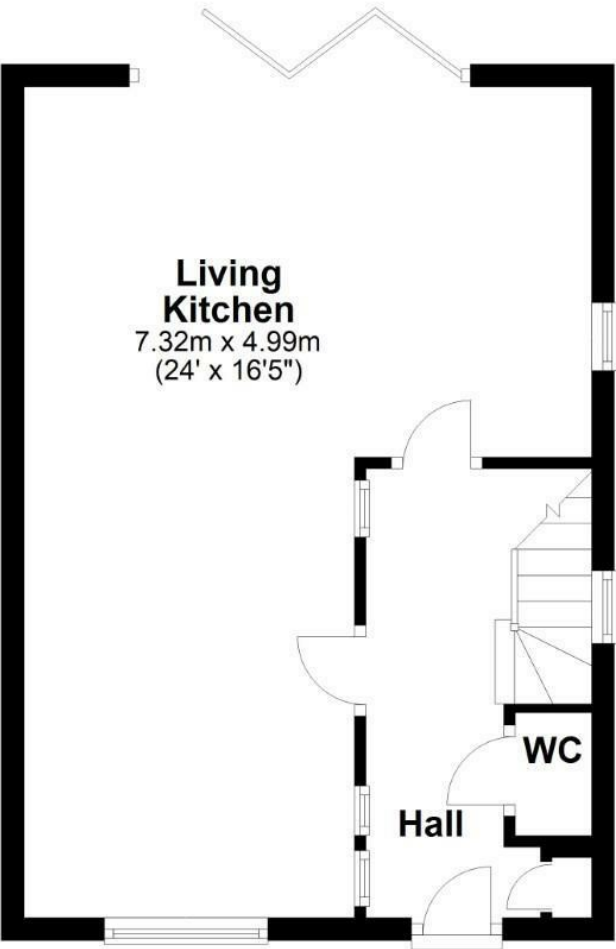

First Floor

Approx. 36.6 sq. metres (393.9 sq. feet)

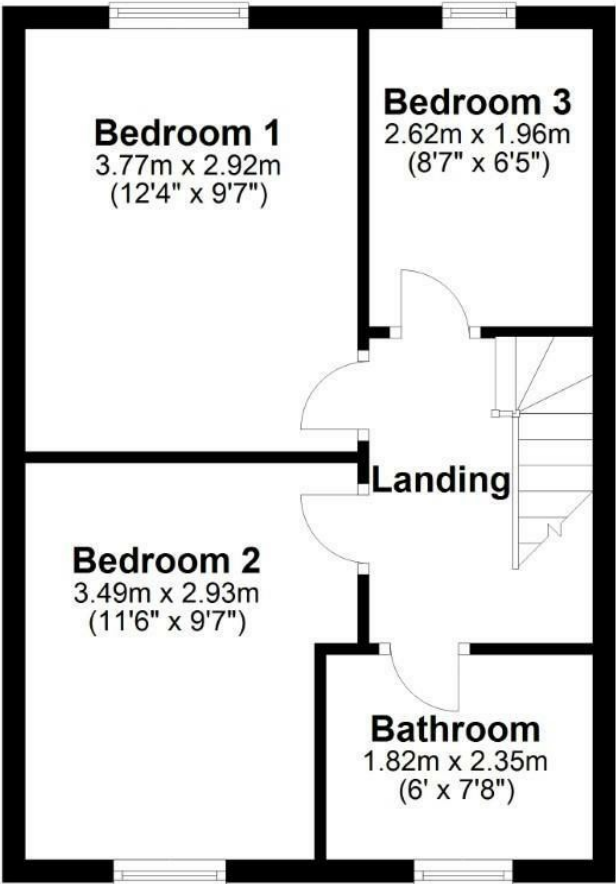

Area Map



Energy Efficiency Graph

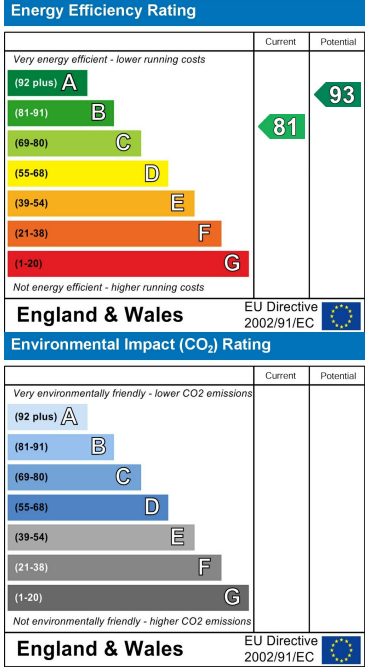

These particulars, whilst believed to be accurate are set out as a general outline only for guidance and do not constitute any part of an offer or contract. Intending purchasers should not rely on them as statements of representation of fact, but must satisfy themselves by inspection or otherwise as to their accuracy. No person in this firms employment has the authority to make or give any representation or warranty in respect of the property.